



# Tables, Sinks & Shelves

Design Guidelines



Our Benches are supplied in standard depths of 600, 700 & 800mm. The 700mm & 800mm range suite perfectly with our sink ranges.

Wall benches have a 60mm upstand to all wall facing sides and 50mm downturn to front. Centre benches have 50mm downturn.

All models have undershelves as standard unless specified open under & height will vary between 850mm & 900mm.

All models are despatched fully assembled with the exception of non standard and oversized items that can be site welded at an additional cost. Sound-deadening pads are fixed under the topwork.

Nonstandard sizes are available at extra cost.

## Shine Tables Spec

There are 3 different specifications:

### Premium

1.5mm 304 Grade Topwork, 304 Grade Undershelf

### Standard:

1.2mm 304 Grade Topwork, 430 Grade Undershelf

### Shine Lite:

1.2mm 430 Grade Topwork, 430 Grade Undershelf



## Standard sizes of Tables

A is length of the tables:

300,600,900,1200,1500,1800,2100,2400 & 3000mm

B is depth: 600, 700 & 800mm

C is height: 850 & 900mm

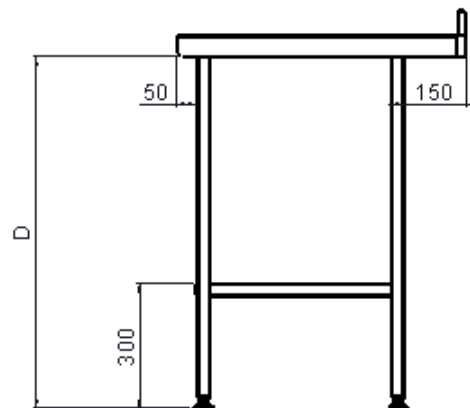
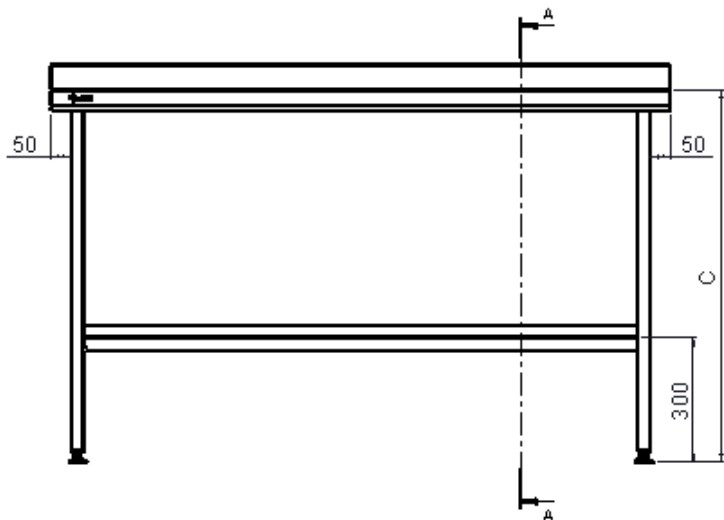
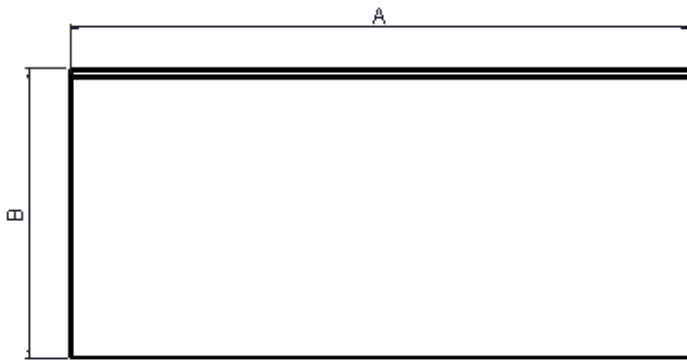

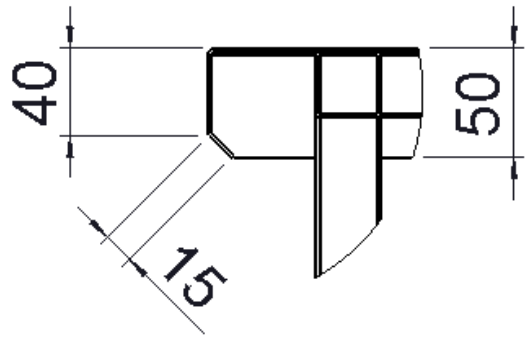

Front Topwork Profile

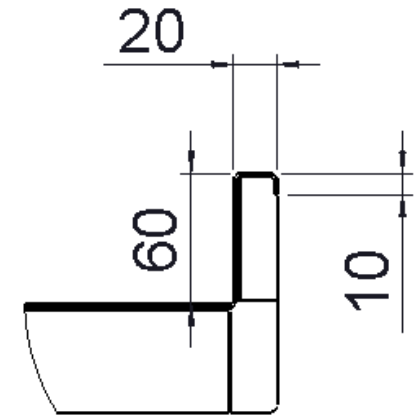

Rear Upstand Profile

Shines Sink units are supplied in standard depths of 700 & 800mm.

Sinks have a 60mm upstand to all wall facing sides and 50mm downturn to front. Centre sinks benches have 50mm downturn.

All models will have undershelves as standard unless specified open under & height will vary between 850mm & 900mm.

All models are dispatched fully assembled with the exception of non-standard and oversized items that can be site welded at additional cost. Sound-deadening pads are fixed under the topwork.

Non-standard sizes are available at extra cost.



## Shine Sink Spec

We have 3 different specifications for our units.  
The main differences between the ranges will be the material used.

### Premium:

2mm 304 Grade Topwork, 304 Grade Undershelf

### Standard:

1.5mm 304 Grade Topwork, 304 Grade Undershelf

### Shine Lite:

1.5mm 304 Grade Topwork, 430 Grade Undershelf

Sink units have 3 standard bowl sizes:

610x450x300mm

500x400x300mm

400x400x300mm

Right hand or left hand drainer option

Front valance supplied as extra

Double Bowls available

Full Anti Drip and Local Anti Drip available







## Wall shelves

We have 2 type of shelves: adjustable and non adjustable.

The non-adjustable ones come with 2 different brackets depending on spec.

Standard lengths are: 300,600,900,1200,1500,1800,2100.



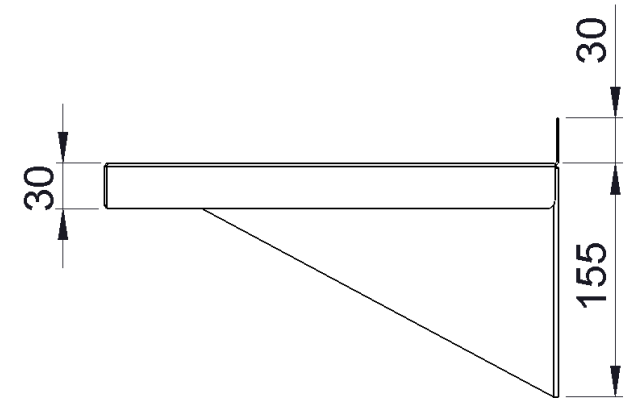
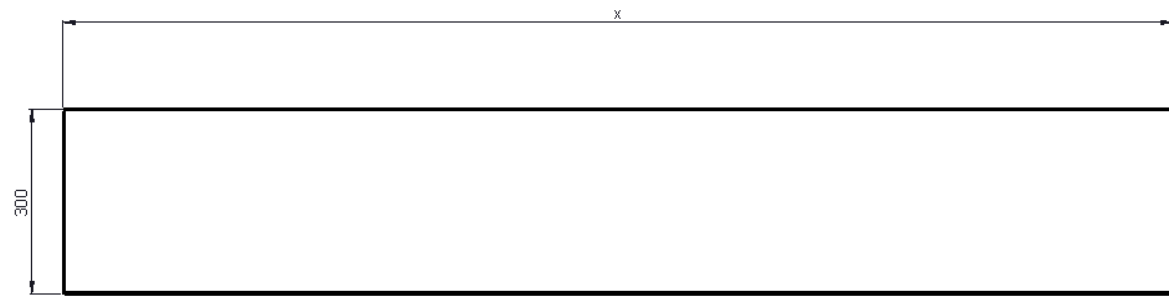

Standard shelves are manufactured in the same 300mm size breaks as other Shine standard units.

The brackets are either folded sheet metal or box brackets depending on specification.



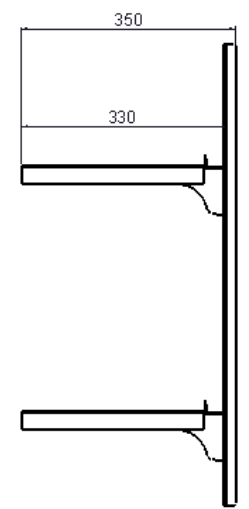
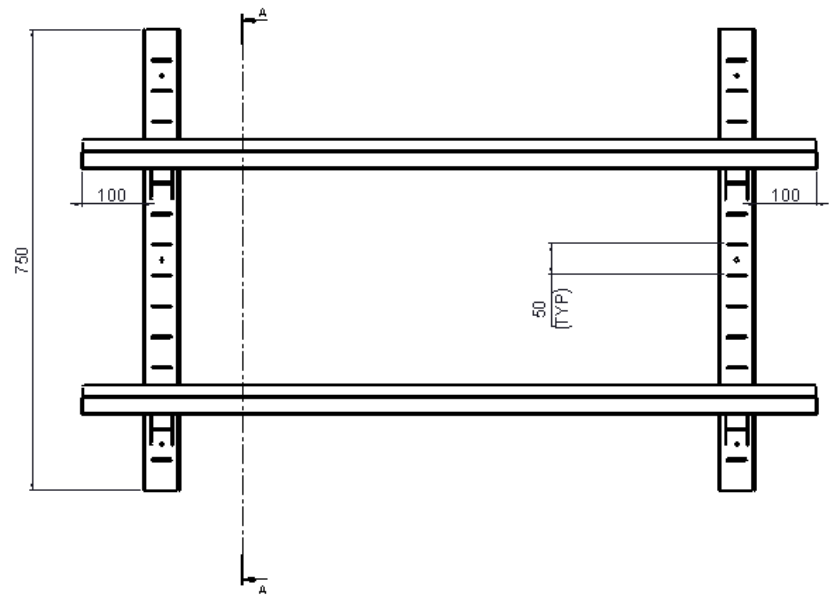
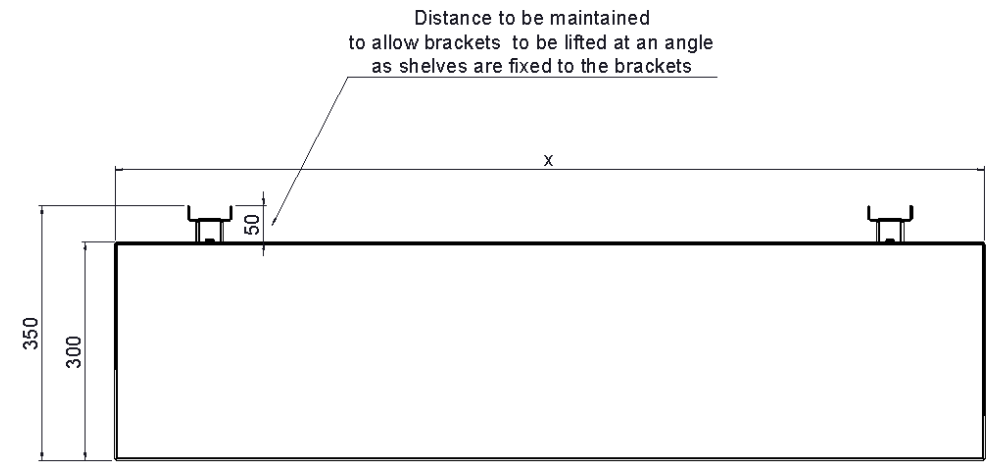
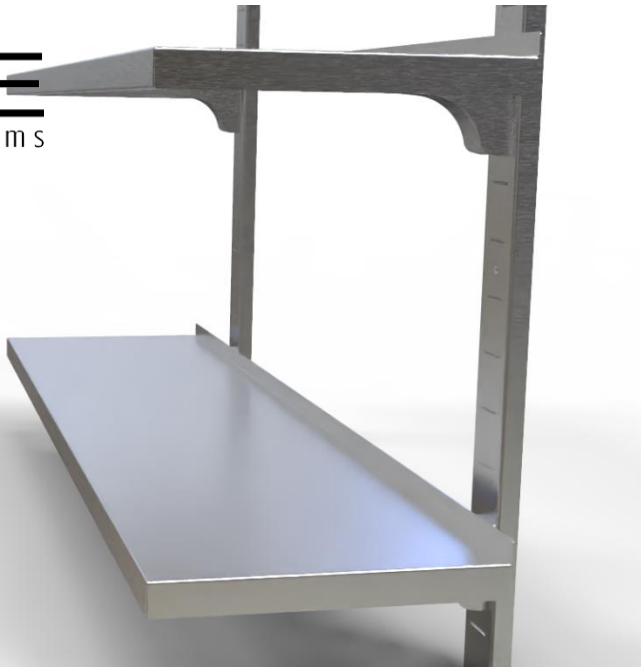

Additional shelves and ladder supports can be provided as extra cost.